

# QUICK START GUIDE

1

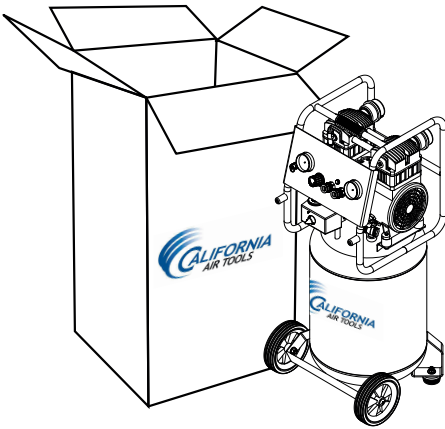

Please Read Manual

2

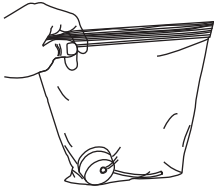

Air Filter Tube Installation

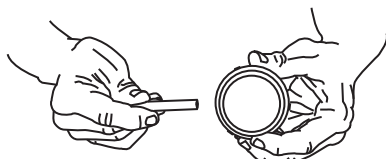

3

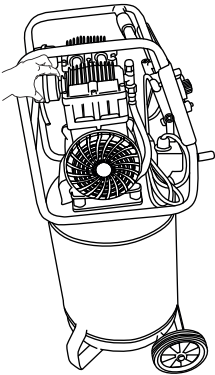

Air Filter Installation

Hand tighten only

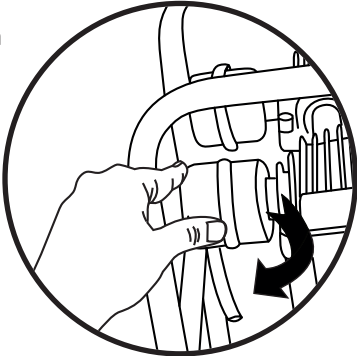

4

1/4" Industrial/ Universal Quick Connect

Push to Connect



## Drain Valve Operation

5

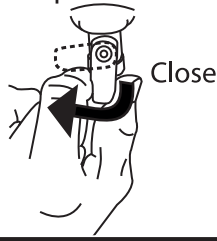
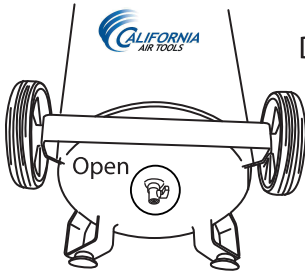

6

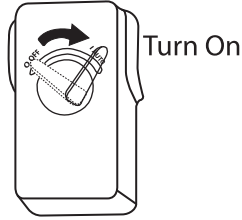
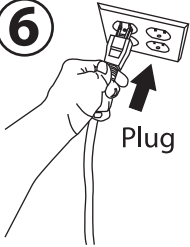

7

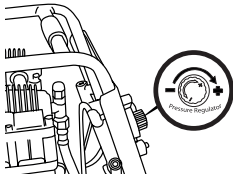

Pressure Regulator  
Turn knob clockwise to rise  
pressure & counterclockwise  
to decrease.

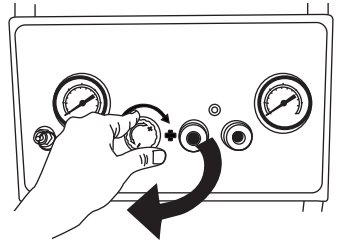

8

Turn Off

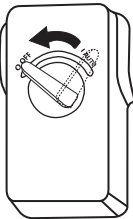

\*Note: Always turn off  
unit before unplugging

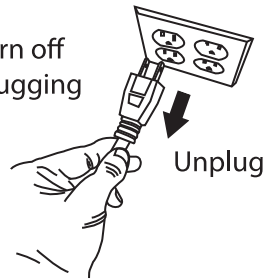

9

