

QUICK START GUIDE

1

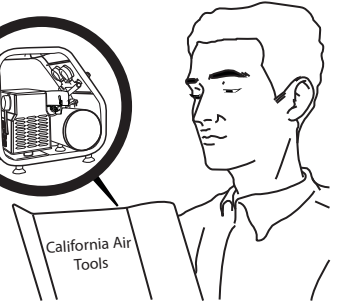
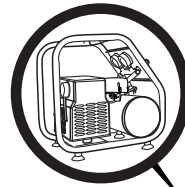
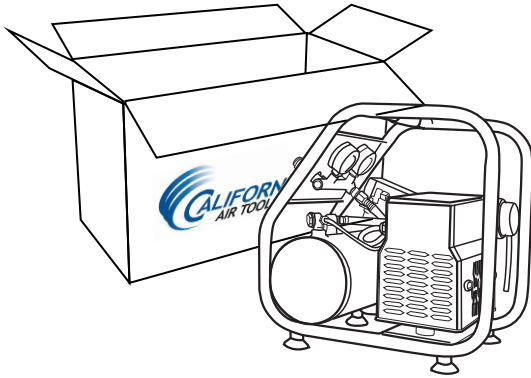

Please Read Manual

2

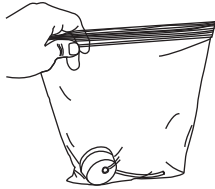

Air Filter Tube Installation

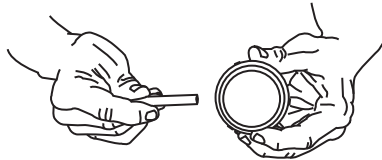

3

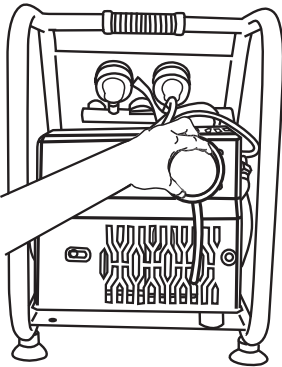

Air Filter Installation

Hand tighten only

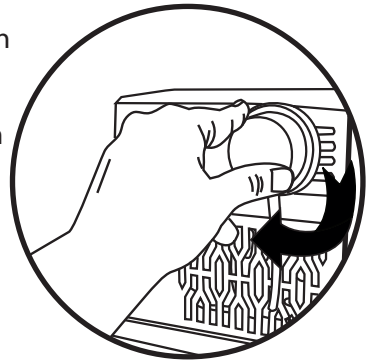

4

¼" Industrial/ Universal Quick Connect

Push to Connect



Drain Valve Operation

5

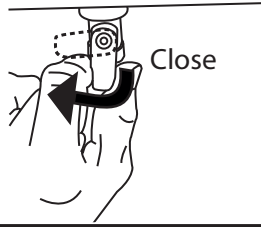
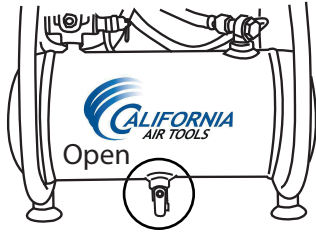

6

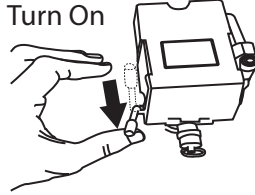
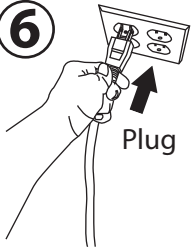

OR

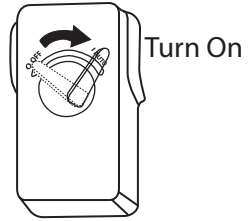

7

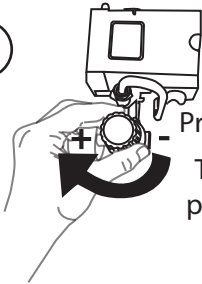

Turn knob clockwise to rise pressure & counterclockwise to decrease.

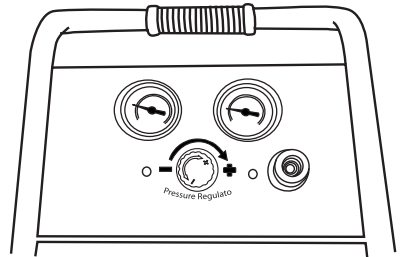

8

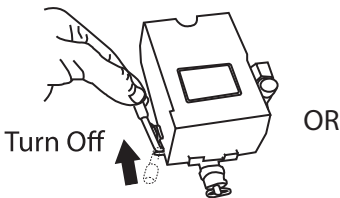

OR

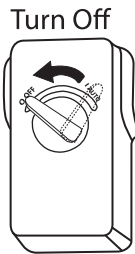

*Note: Always turn off unit before unplugging

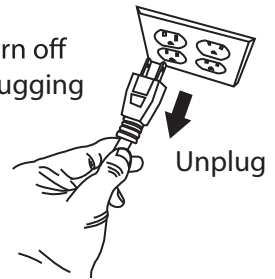

9

